



TRUclean
GCS

Solvent or Aqueous Media Gun Washer
TC-GC-01 (904200)



For other languages of this service manual as well as additional product information, please scan the QR code above.

In this part sheet, the words **WARNING**, **CAUTION** and **NOTE** are used to emphasize important safety information as follows:

WARNING

Hazards or unsafe practices which could result in severe personal injury, death or substantial property damage.

CAUTION

Hazards or unsafe practices which could result in minor personal injury, product or property damage.

NOTE

Important installation, operation or maintenance information.

WARNING

Read the following warnings before using this equipment.



READ THE MANUAL

Before operating finishing equipment, read and understand all safety, operation and maintenance information provided in the operation manual.



OPERATOR TRAINING

All personnel must be trained before operating finishing equipment.



EQUIPMENT MISUSE HAZARD

Equipment misuse can cause the equipment to rupture, malfunction, or start unexpectedly and result in serious injury.



LOCK OUT / TAG-OUT

Failure to de-energize, disconnect, lock out and tag-out all power sources before performing equipment maintenance could cause serious injury or death.



AUTOMATIC EQUIPMENT

Automatic equipment may start suddenly without warning.



PRESSURE RELIEF PROCEDURE

Always follow the pressure relief procedure in the equipment instruction manual.



KEEP EQUIPMENT GUARDS IN PLACE

Do not operate the equipment if the safety devices have been removed.



KNOW WHERE AND HOW TO SHUT OFF THE EQUIPMENT IN CASE OF AN EMERGENCY



WEAR SAFETY GLASSES

Failure to wear safety glasses with side shields could result in serious eye injury or blindness.



INSPECT THE EQUIPMENT DAILY

Inspect the equipment for worn or broken parts on a daily basis. Do not operate the equipment if you are uncertain about its condition.



NEVER MODIFY THE EQUIPMENT

Do not modify the equipment unless the manufacturer provides written approval.



NOISE HAZARD

You may be injured by loud noise. Hearing protection may be required when using this equipment.

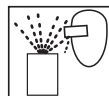

PROJECTILE HAZARD

You may be injured by venting liquids or gases that are released under pressure, or flying debris.



PINCH POINT HAZARD

Moving parts can crush and cut. Pinch points are basically any areas where there are moving parts.



STATIC CHARGE

Fluid may develop a static charge that must be dissipated through proper grounding of the equipment, objects to be sprayed and all other electrically conductive objects in the dispensing area. Improper grounding or sparks can cause a hazardous condition and result in fire, explosion or electric shock and other serious injury.



WEAR RESPIRATOR

Toxic fumes can cause serious injury or death if inhaled. Wear a respirator as recommended by the fluid and solvent manufacturer's Safety Data Sheet.



TOXIC FLUID & FUMES

Hazardous fluid or toxic fumes can cause serious injury or death if splashed in the eyes or on the skin, inhaled, injected or swallowed. LEARN and KNOW the specific hazards or the fluids you are using.



FIRE AND EXPLOSION HAZARD

Improper equipment grounding, poor ventilation, open flame or sparks can cause a hazardous condition and result in fire or explosion and serious injury.



MEDICAL ALERT

Any injury caused by high pressure liquid can be serious. If you are injured or even suspect an injury:

- Go to an emergency room immediately.
- Tell the doctor you suspect an injection injury.
- Show the doctor this medical information or the medical alert card provided with your airless spray equipment.
- Tell the doctor what kind of fluid you were spraying or dispensing.



GET IMMEDIATE MEDICAL ATTENTION

To prevent contact with the fluid, please note the following:

- Never point the gun/valve at anyone or any part of the body.
- Never put hand or fingers over the spray tip.
- Never attempt to stop or deflect fluid leaks with your hand, body, glove or rag.
- Always have the tip guard on the spray gun before spraying.
- Always ensure that the gun trigger safety operates before spraying.

IT IS THE RESPONSIBILITY OF THE EMPLOYER TO PROVIDE THIS INFORMATION TO THE OPERATOR OF THE EQUIPMENT. FOR FURTHER SAFETY INFORMATION REGARDING THIS EQUIPMENT, SEE THE GENERAL EQUIPMENT SAFETY BOOKLET (77-5300).

TRU-CLEAN – GENERAL INFORMATION

PURPOSE OF THE MACHINE

The unit is intended for cleaning of air-driven spray guns using either thinner-based solvents or water-based solvents.

All other use of the unit are not allowed like:

- Emptying excess paint into the unit
- Cleaning of electric chargeable items
- Collecting of various waste
- Cleaning of textile materials
- Storing of items
- Cleaning of hands or other parts of the human body
- Cleaning of any items for food or drinks

PERMITTED SOLVENTS

The unit can be used with solvents and solvent mixtures intended for spray gun cleaning, such as acetone, toluene, isobutanol, xylene that are listed as Group IIA according to IEC 79-20 (EN 60079-20).

The unit can also be used with water or water based solvents.

All solvents must have a pH value between 4 and 10. Be sure not to mix water-based solvents with thinner-based solvents. It is important that all users are informed of what solvent is being used, at all time.

Never use any solvent if it is not provided with an SDS (Safety Data Sheet). Read the SDS carefully, and follow all the instructions and procedures provided in the SDS. If unsure, or if more information is needed concerning the solvent, please contact your solvent supplier.

Do not add other chemicals to the solvent including, but not limited to, kerosene, gasoline, detergents, fuel oil or chlorinated solvents.

PERMITTED SOLVENT DRUMS

The Trisk | DeVilbiss TruClean can be used with different types of drums, but they must comply with the following:

- The drums must fit into the unit
- The drums must be leak-free.
- The drums must be made of a conductive material.
- Check for local regulations concerning max allowed volume for keeping solvent in the unit

Solvent drums are not provided by Trisk | DeVilbiss, thus Trisk | DeVilbiss does not take any responsibility for the drums. Follow the solvent supplier's instructions carefully.

COLLECTING TRAY

The unit must be installed in such a way as to prevent accidental leakage of solvent from spreading into a drain water system, thus representing a hazard to the environment. This can be done by:

- installing the unit in a location where floor and walls can hold any accidental drum leakage, or
- equipping the unit with a collecting tray beneath the solvent drums that is large enough to hold the volume of at least one leaking drum.

SAFETY INFORMATION

Hazards may arise from improper use of the Trisk | DeVilbiss TruClean. Hazards may also arise from improper choice/handling of drums or solvent. In order to maintain the high safety standard of the unit, it is important that these instructions are followed.

- Do not operate the unit until you have read and fully understood this entire User's Manual.
- The unit should be installed as described in the instructions.
- The unit should be used as described in the instructions.
- The unit should be maintained as described in the instructions.
- Only original spare parts may be used.
- This User's Manual must be available and in legible condition in close proximity to the unit. Every user shall know where to find the User's Manual.
- Operating instructions should be formulated on the basis of this Users Manual, and translated into the language spoken by the employees.
- Do not modify or in any way alter the unit.
- Do not operate the unit unless it is properly vented. Do not operate the unit if the extraction of vapors is insufficient.
- Avoid contact with liquid and vapor. Refer to the solvents' SDS (Safety Data Sheet).
- Wear chemical goggles or similar, to protect your eyes. Wear chemical-resistant gloves to prevent skin-contact. Wear chemical-resistant clothing to protect against spills or splash.
- Personnel suffering from respiratory problems or allergies to solvents used, must not operate the machine.

TRU-CLEAN – SETUP

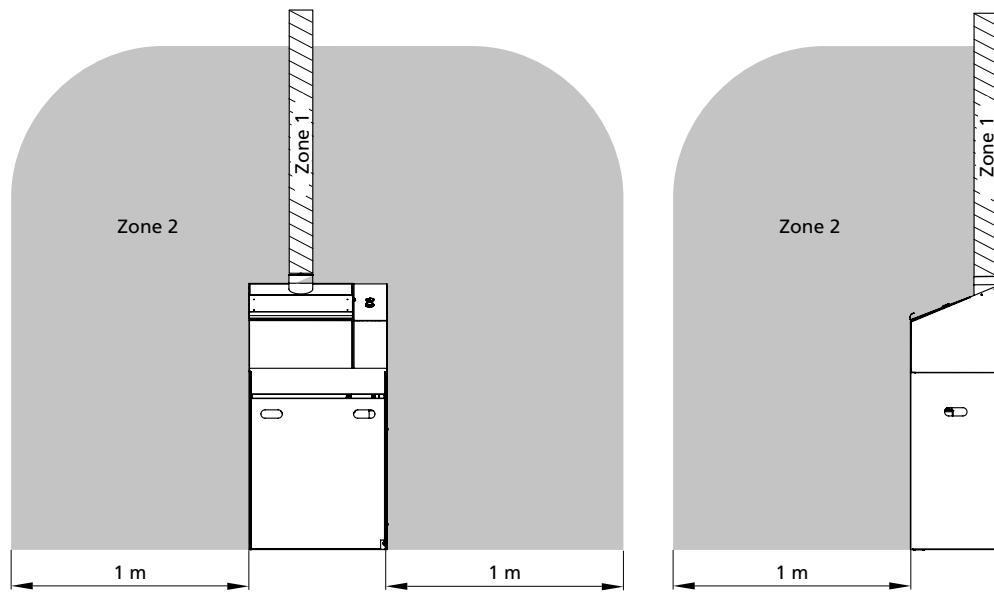

- Clean up spills immediately. Solvent vapours are heavier than air and can spread a long way. They may also collect in pits or other low areas.
- Do not smoke, eat or drink while close to the unit.
- The unit is equipped with a safety valve that will interrupt the automatic wash cycle if the lid is opened before the wash cycle is completed.
- A fire extinguisher must always be kept nearby when working with flammable solvents. Do not use water.
- Spray guns or any other paint equipment items cleaned in the unit must be suitable for cleaning in a Zone 1 area (ref. Category 2 according to EN 13463-1/2001). If unsure, please contact the spray gun manufacturer.
- The unit must be properly grounded using the attached grounding cable. If plastic drums are used, the openings should be wiped off with a damp cloth, to avoid static electricity, before inserting or removing any hoses or other equipment.

OPERATING INSTRUCTIONS

Operating instructions should be formulated on the basis of this manual and translated into the language spoken by the employees. It should be close to the machine. To avoid confusion, the employees must be informed about the solvent currently being used in the machine.

UNPACKING

For instructions, see "Unpacking Instructions".

PLACING THE UNIT

The Trisk | DeVilbiss TruClean is equipment Category 2 (ref. ATEX-directive 2014/34/EU) and may therefore be placed in locations classified as Zone 1 (ref. ATEX-directive 1999/92 EC).

If the Trisk | DeVilbiss TruClean is installed in locations classified as Zone 2 or in unclassified locations, the following is valid provided that the ventilation of the unit is installed as described further down in this manual: The space within 1 m of the Trisk | DeVilbiss TruClean is to be classified as Zone 2, and the inside of the ducting as Zone 1 (see illustration above).

Within these areas, all equipment such as electrical items must be approved for the Zones described. Equipment that generates naked flames or sparks (e.g. welding or grinding equipment) may not be used in this area. Smoking is not permitted. If in any doubt, please contact the local fire service authorities for advice.

This manual is part of the unit and must be available at all times.

TRU-CLEAN – SETUP

VENTILATION

There are two different options for the unit's ventilation:

1. Lead the exhaust outdoors.
2. Lead the metal ducting into a hood that is in turn connected to a suitable ventilation system approved for Zone 1. This hood should have an open design to avoid constant extraction. The metal ducting may not be longer than 15 metres, and must be connected in such a way as to ensure grounding.

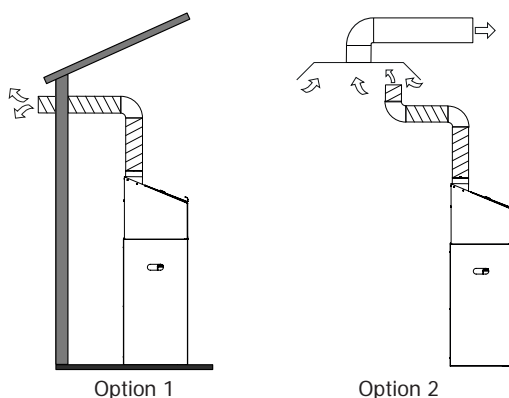

COMPRESSED AIR AND GROUNDING

The air is to be connected inside the unit.

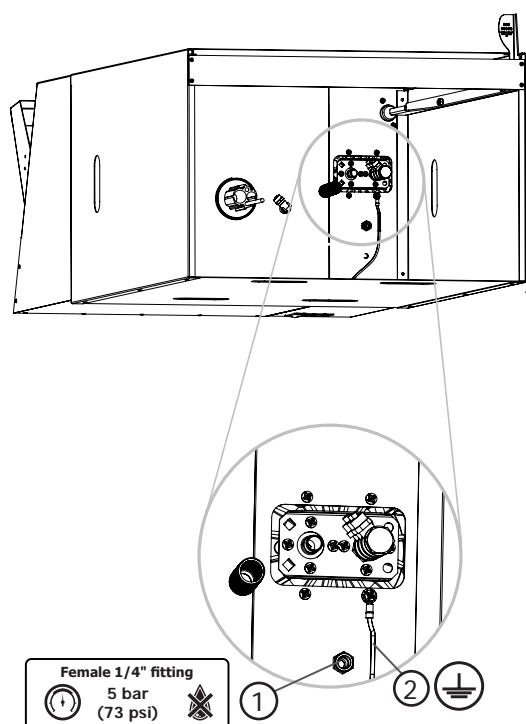

The compressed air supplied to the unit must be clean and dry. If it is not first led through a water trap and filter, it may cause damage to the pneumatic components of the unit, which will invalidate any warranty claims.

Make sure that the unit is properly grounded using the grounding cable supplied.

PREPARATIONS FOR USE

Open the front plate.

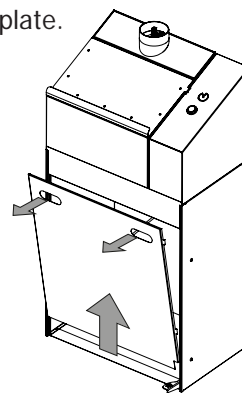

Solvent drums

Two drums are needed, one drum that is empty, and one drum full of solvent. Both drums must be of the same size, fit inside TruClean, and they must meet the requirements described under chapter PERMITTED SOLVENT DRUMS. Both drums must be clean on the inside and they must not contain any solids or other objects that could be sucked into the pumps when running.

Prepare drums

Pour half of the solvent from the full drum to the empty one.

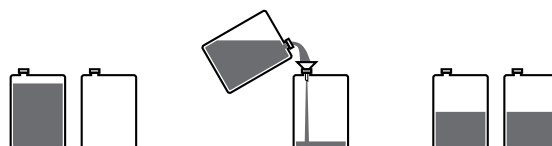

Drum plugs

With the unit, two cardboard boxes with a selection of tapered plugs are supplied. Select the plugs that fit best into the opening of the drums.

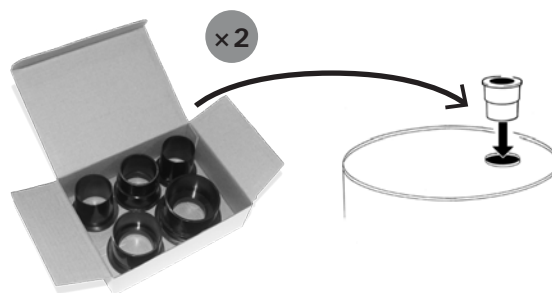

TRU-CLEAN – OPERATION

Place the two drums in the cabinet.

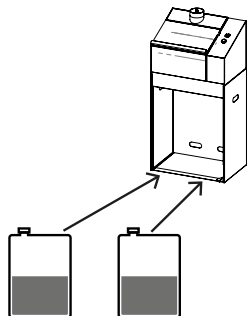

Fit the drum adaptors to the drum plugs.

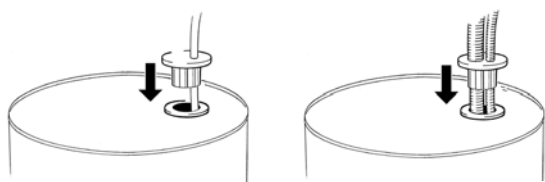

The drum on the **left side** will contain the clean solvent. Connect the adapter plug with the **single hose** to it.

The drum on the **right side** will contain the recirculating solvent. Connect the adapter plug with the **two hoses** to it.

The solvent system is now filled-up. Both drums should be half full. When manual rinsing is done, the contents of the left drum will gradually be used up and transferred to the right drum.

Prepare air line

The air line (Figure 3.2) is used in the automatic wash cycle. A set of conical plugs are provided. Select the plug that best fit the spray gun's air inlet, and mount it on the air line.



OPERATING INSTRUCTIONS

Empty the spray gun of any residual paint into a separate spills-dish. Place the cup and lid onto the wash compartment (Figure 3.3).

It is recommended that the spray gun is dismantled and the parts placed in the washing compartment for best cleaning results.

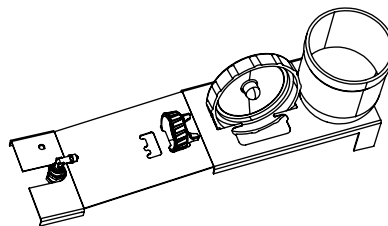

Be sure to fit the trigger clip:

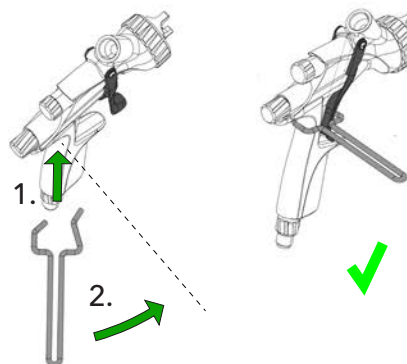

Connect the air line to the gun (Figure 3.2).

Place gun on cone (Figure 3.6). The air line prevents solvent from entering the spray gun's air channels during washing.

Close the lid, and start the automatic pre-wash cycle by pressing the button (Figure 2.4). The spray gun will now be automatically cleaned for approximately 90 seconds with circulating solvent.



Automatic cleaning cycle = 90 seconds.

When the cleaning procedure is completed, the lid can be opened and the spray gun taken out.

Manual rinsing

The spray gun can be manually rinsed with clean solvent if required. Stepping on the pedal will spray a jet of clean solvent from the nozzle under the lid.

TRU-CLEAN – OPERATION

FIGURE 2

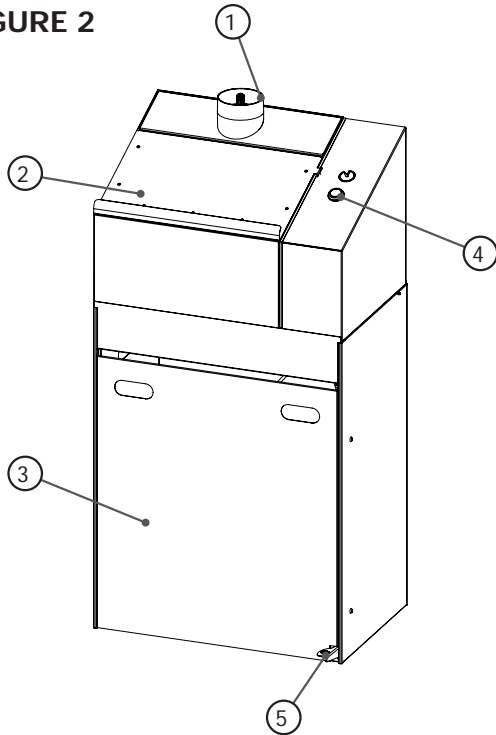
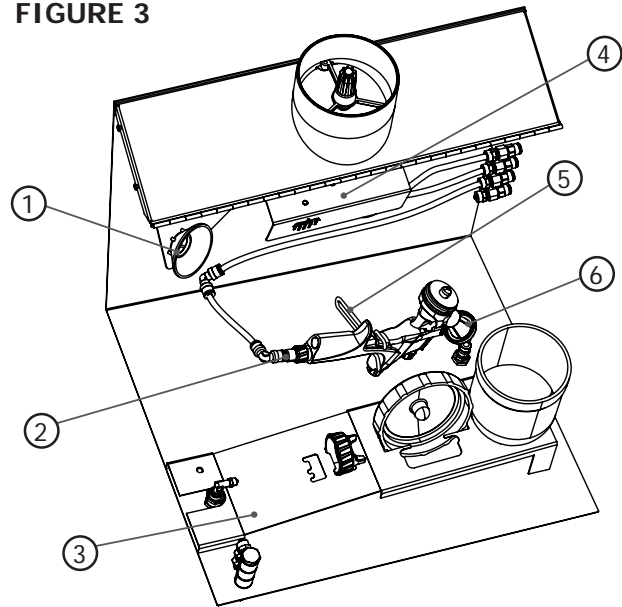

FIGURE 3



Finally, it is possible to blow out the spray gun. Connect the spray gun to the air line (optional), and blow out the spray gun through the funnel under the lid (Figure 3.1).

By using this funnel, you prevent the fumes from spreading within the premises.

Close the lid after cleaning.

SERVICE

Monthly:

- Carefully remove to not damage or break the three nozzles used for automatic washing and clean them with fresh solvent.

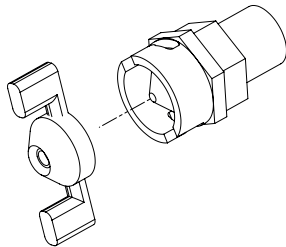

When changing drums:

- Check and if necessary clean the strainer (Sieve 15018) on the suction hose for circulating solvent.

TECHNICAL DATA

Type of machine:	Trisk DeVilbiss TruClean
Permitted solvents:	See section "Permitted Solvents"
Max solvent volume of machine:	25 litres (12,5 + 12,5 litres) (Check for local regulations concerning max allowed volume for keeping solvent in the unit)
Maximum drum size:	25 litres
Compressed air needed:	5 bar (72.5 psi) 90 l/min (3 cfm) pump only 370 l/min (14 cfm)
Ventilation capacity required:	200-500 m³/h (118-294 cfm) -> 0,2-0,5 m/s (0,7-1,6 fps)
Pump capacity:	10 l/min
Solvent pressure	2 bar (30 psi)
Weight	30 kg (73 lb)
Overall dimensions:	Height: 1120 mm (44.1") Width: 582 mm (22.9") Depth: 385 mm (15.2")
Extractor diameter:	100 mm (3.9")
Sound pressure level:	<70 dB(A)

TROUBLESHOOTING

General Fault	Cause	Correction	Corresponding Item/Part
Limited or no flow during wash cycle	Limited or no flow during wash cycle	Clean or replace	
	Suction hose not picking up solvent due to leakage or empty solvent drum	Check suction hose for leaks	
	Spray nozzles in wash basin blocked	Remove and clean nozzles	
	Check valves in pump not sealing or blocked	Remove pump connectors and clean valves/remove obstacles. Re-assemble according to picture	
Pump does not stop after 1,5min	Timer air leak unit blocked	Replace Timer leak unit	⑤
	Start valve leaking continuously	Replace start valve	②
Pump not operating	Check air pressure and feed hose	Secure air pressure of 5-6 bar (72-87 PSI)	
	Check start valve function	Replace start valve	②
	Lid tab not reaching safety valve	Check for damages on lid tab	
	Safety valve malfunctioning	Replace safety valve	③
Ventilation does not start when opening lid	Safety valve malfunctioning		
Manual spray nozzle in wash basin not functioning when pressing pedal	Spray valve not opening	Check pedal and push rod function	④
		Replace spray valve or gas pedal assembly	⑦
Manual spray nozzle not spraying solvent	No solvent pick-up by 6mm suction hose	Check that hose reaches down into solvent drum	
	Nozzle blocked by debris	Remove 6 mm suction hose from drum and use air gun to back flush nozzle	
Extraction not efficient	Air line / Air feed / Air pressure limits	Ensure proper air feed to unit according to technical data	
	Ventilation nozzle is blocked, For example by paint build-up	Replace nozzle	⑥

SPARE PARTS

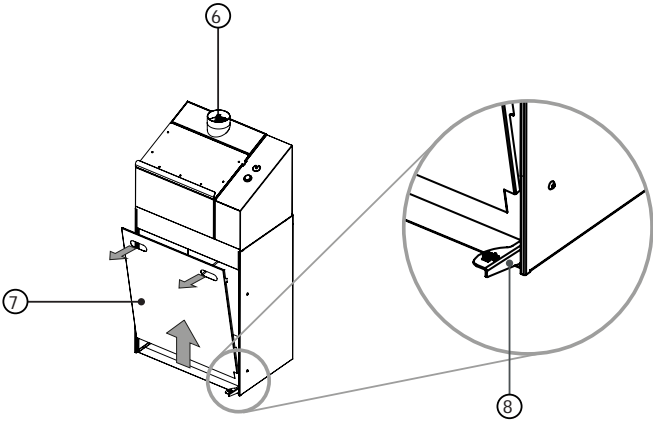
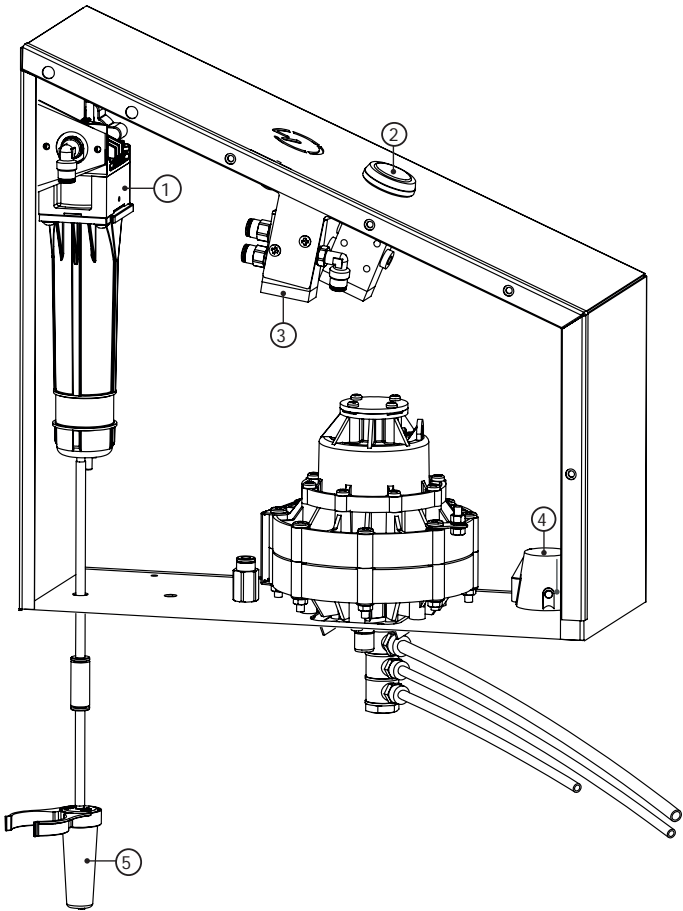

SPARE PARTS LIST

Ref. No.	Replacement Part No.	Description	Ind. Parts Req'd.
1	410-2000 (US 992000)	TIMER	1
2	410-2001 (US 992001)	START VALVE	1
3	410-2002 (US 992002)	SAFETY VALVE	1
4	410-2003 (US 992003)	PEDAL HOSE	1
5	410-2004 (US 992004)	CAPILLARY UNIT (BLACK)	1
6	410-2008 (US 992008)	VENTILATION NOZZLE	1
7	410-2005 (US 992005)	FRONT PLATE	1
8	410-2006 (US 992006)	PEDAL ASSEMBLY	1

ACCESSORIES

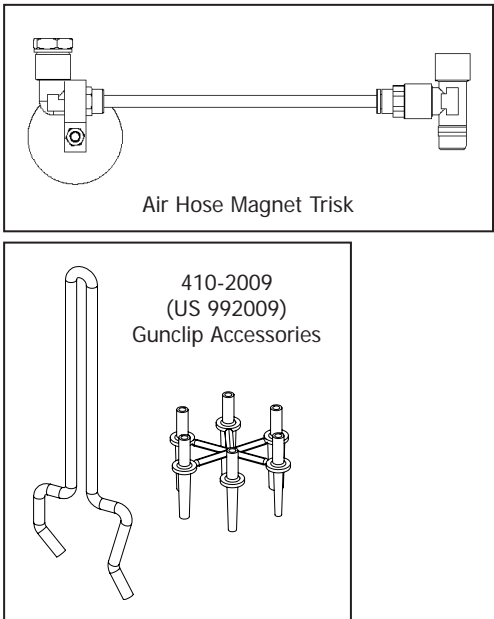
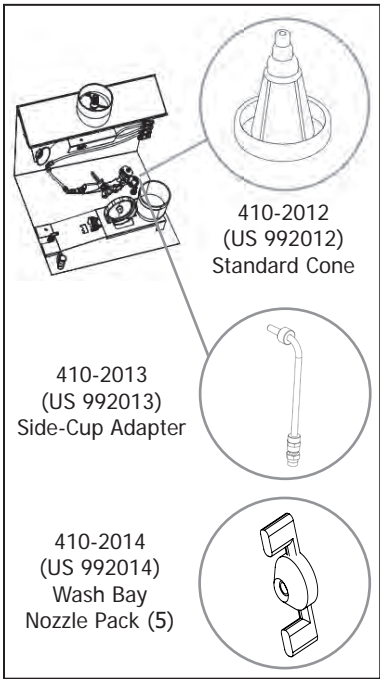

NOTES

NOTES

WARRANTY POLICY

This product is covered by Carlisle Fluid Technologies' materials and workmanship limited warranty. The use of any parts or accessories, from a source other than Carlisle Fluid Technologies, will void all warranties. Failure to reasonably follow any maintenance guidance provided may invalidate any warranty.

For specific warranty information please contact Carlisle Fluid Technologies.

For technical assistance or to locate an authorized distributor, contact one of our international sales and customer support locations.

Region	Industrial / Automotive	Automotive Refinishing
Americas	Tel: 1-800-992-4657 Fax: 1-888-246-5732	Tel: 1-800-445-3988 Fax: 1-800-445-6643
Europe, Africa, Middle East, India	Tel: +44 (0)1202 571 111 Fax: +44 (0)1202 573 488	
China	Tel: +8621-3373 0108 Fax: +8621-3373 0308	
Japan	Tel: +81 45 785 6421 Fax: +81 45 785 6517	
Australia	Tel: +61 (0) 2 8525 7555 Fax: +61 (0) 2 8525 7575	

For the latest information about our products, visit www.carlisleleft.com

Carlisle Fluid Technologies is a global leader in innovative finishing technologies. Carlisle Fluid Technologies reserves the right to modify equipment specifications without prior notice.

BGK™, Binks®, DeVilbiss®, Hosco®, MS®, and Ransburg® are all registered trademarks of Carlisle Fluid Technologies, LLC.

©2022 Carlisle Fluid Technologies, LLC.
All rights reserved.



16430 North Scottsdale Rd., Suite 450 Scottsdale, AZ 85254 USA