



**JGA®**  
**CONVENTIONAL**  
**PRESSURE FEED GUN**



Order No. **110271** Model No. **JGA-504-765-12**

Order No. **110274** Model No. **JGA-504-777-14**

**High Production,**  
**High Performance**

**Worldwide choice for**  
**large area refinishing**

**JGA® Conventional Pressure Feed Guns**

Order No. Model No.	Fluid Tip Type	Fluid Tip (mm)	Inlet Pressure	Application	Fluid Flow
<b>110271</b> <b>JGA-504-765-12</b>	CNV.	1.2	60-65 PSI	High solids fleet materials	7-13 oz./min.
<b>110274</b> <b>JGA-504-777-14</b>	CNV.	1.4	50-80 PSI	High solids fleet materials	9-17 oz./min.

CNV. = Conventional

**JGA® Conventional Pressure Feed Air Cap**

<b>#765</b> <b>air cap</b>	<b>High solids</b> Air Cap Order No. <b>192310</b> Air Cap Model No. <b>AV-440-765</b> 60-65 PSI inlet Fluid tip 1.2 mm	<b>192310</b> <b>AV-440-765</b> 19-22 CFM	<b>Air Cap Pattern</b> <b>11-14"</b>
<b>#777</b> <b>air cap</b>	<b>High solids</b> Air Cap Order No. <b>192066</b> Air Cap Model No. <b>AV-440-777</b> 50-80 PSI inlet Fluid tip 1.4 mm	<b>192066</b> <b>AV-440-777</b> 17-25 CFM	<b>Air Cap Pattern</b> <b>11-14"</b>

Refer to Service Bulletin: SB-2-259

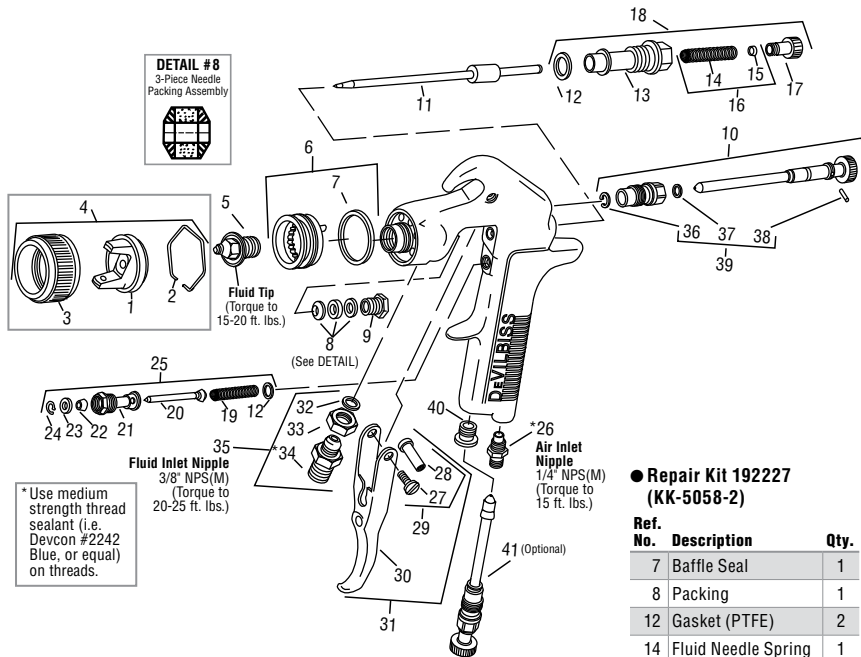

**● Repair Kit 192227 (KK-5058-2)**

Ref. No.	Description	Qty.
7	Baffle Seal	1
8	Packing	1
12	Gasket (PTFE)	2
14	Fluid Needle Spring	1
15	Spring Pad	1
19	Air Valve Spring	1
20	Air Valve	1
22	U Cup Seal	1
23	Washer	1
24	Snap Ring	1
32	Fluid Inlet Gasket	1
36	Retaining Clip	1
37	Seal	1
38	Pin	1

● A quantity of necessary parts is included in 192227 Repair Kit (KK-5058-2) for complete gun repair and should be kept on hand for service convenience.

**Suffixes:** -K5 designates kit of multiple parts.  
Example: JGA-4035-K5 is a kit of 5 packings.

Ref. No.	Order No.	Model No.	Description	Ind. Parts Req.
1	—	—	Air Cap	1
2	191972	JGA-156-K10	Spring Clip (Kit of 10)	1
3	192042	GTI-3	Air Cap Retaining Ring	1
4	See Chart 1	—	Air Cap & Retaining Ring	1
5	See Chart 1	—	Fluid Tip	1
6	192178	GTI-425	Baffle Assembly	1
●7	192179	GTI-33-K5	Baffle Seal (Kit of 5)	1
●8	192109	JGA-4035-K5	Packing (Kit of 5)	1
9	190893	34411-122-K10	Packing Nut (Kit of 10)	1
10	192051	GTI-405	Spreader Valve Assy	1
11	See Chart 1	—	Fluid Needle	1
●12	190161	JGS-72-K10	Gasket (PTFE) (Kit of 10)	2
13	—	—	Body Bushing	1
●14	—	—	Fluid Needle Spring	1
●15	—	—	Spring Pad	1
16	190894	MBD-19-K10	Spring & Pad (Kit of 10)	1
17	192043	GTI-414	Needle Adjusting Screw	1
18	192139	KK-5059	Bushing, Spring, Pad & Knob Kit	1
●19	—	—	Air Valve Spring	1
●20	—	—	Air Valve	1
21	—	—	Air Valve Body	1
●22	—	—	U Cup Seal	1
●23	—	—	Washer	1
●24	—	—	Snap Ring	1
25	190780	JGS-449-1	Air Valve Assembly	1
26	190287	P-MB-51	Air Inlet Nipple 1/4" NPS(M)	1
27	—	—	Trigger Stud Screw	1
28	—	—	Trigger Stud	1
29	190889	JGS-478	Stud & Screw Kit (3 Studs & 5 Screws)	1
30	—	—	Trigger	1
31	191943	JGS-477-1	Trigger, Stud & Screw Kit	1
●32	—	—	Fluid Inlet Gasket (PTFE)	1
33	—	—	Locknut	1
34	—	—	Fluid Inlet Adapter	1
35	190888	JGA-4042	Fluid Inlet, Gasket & Nut Kit	1
●36	—	—	Retaining Clip	1
●37	—	—	Seal	1
●38	—	—	Pin	1
39	192229	GTI-428-K5	Clip, Seal & Pin Kit (5 Each)	1
40	190828	JGA-132	Plug	1
41	192228	GTI-415	Air Adjusting Valve (Optional)	1

**Chart 1**

If this no. is on air cap, order →	Air Cap with Ring (Ref. No. 4)	Fluid Needle (Ref. No. 11)	Fluid Tips Used (Ref. No. 5)
765	192310 AV-440-765	192311 GTI-449-12	192168 AV-213-12
777	192066 AV-440-777	192311 GTI-449-12	192170 AV-213-14